

LP92572
EDITION 1
APPROVED 30/7/71

<p>PLAN OF SUBDIVISION OF PART OF CROWN ALLOTMENT 50 PARISH OF WEEAPROINAH COUNTY OF POLWARTH</p>  <p>SCALE OF CHAINS</p>	<p>APPROPRIATIONS</p>
--	-----------------------

V 8800 1838

CONSENT OF COUNCIL

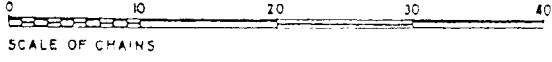
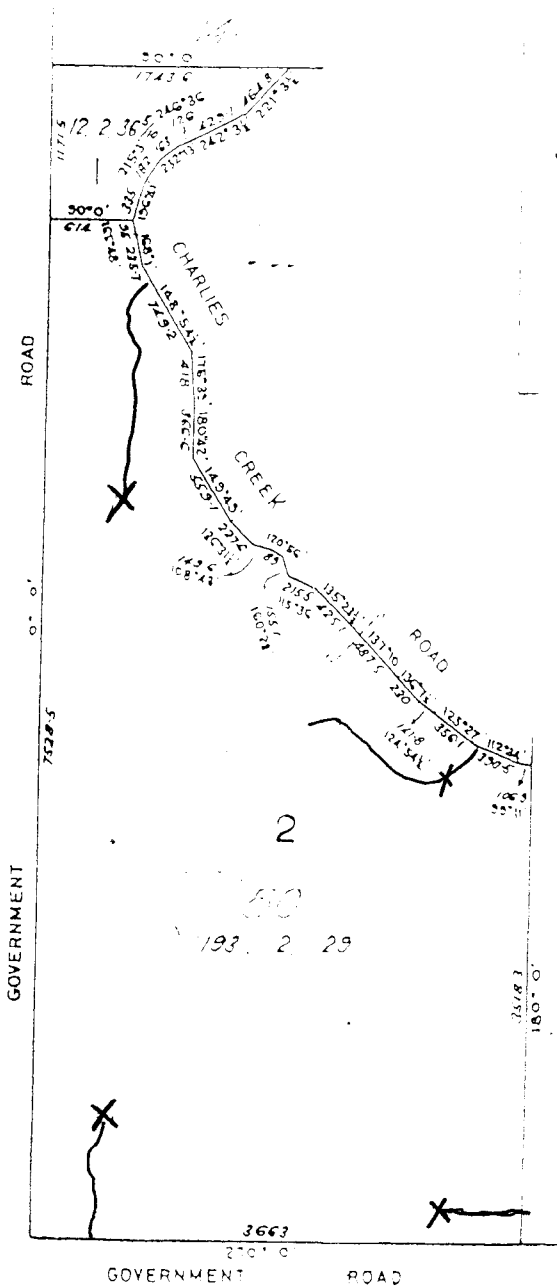

1971 May 11 1971

X Landing.

SURVEYORS CERTIFICATION

I certify that this Plan has been made by me, Vivian Kirby Hand, and accords with Title (C/T, Vol. 8800 Fol. 938) and is mathematically correct and that the boundary between Lots 1 and 2 has been marked on the ground by survey.

Vivian Kirby Hand
Licensed Surveyor